

# FJ-SA2

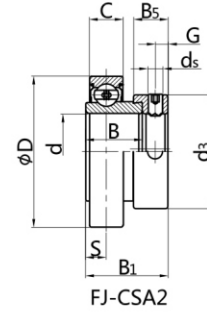
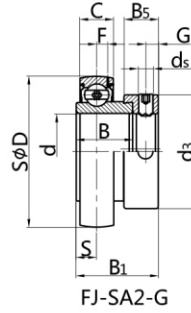
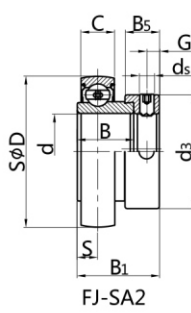

Bearing NO.	Dimensions ( mm / in. )											Dynamic load ratings(N)	Static load ratings(N)	Weight (kg)
	d	D	B1	B	C	S	ds	G	F	B5	d3			
FJ-SA201	12	40	28.6	19.1	12	6.5	M6X1	4.8	3.4	13.5	28.6	7360	4480	0.14
201-8	1/2	1.5748	1.1260	0.7520	0.4724	0.256	1/4-28UNF	0.189	0.134	0.531	1.126			0.13
FJ-SA202	15	40	28.6	19.1	12	6.5	M6X1	4.8	3.4	13.5	28.6	7360	4480	0.12
202-9	9/16	1.5748	1.1260	0.7520	0.4724	0.256	1/4-28UNF	0.189	0.134	0.531	1.126			0.13
202-10	5/8													0.12
FJ-SA203	17	40	28.6	19.1	12	6.5	M6X1	4.8	3.4	13.5	28.6	7360	4480	0.11
203-11	11/16	1.5748	1.1260	0.7520	0.4724	0.256	1/4-28UNF	0.189	0.134	0.531	1.126			0.11
FJ-SA204	20	47	31.0	21.5	14	7.5	M6X1	4.8	4.2	13.5	33.3	12800	6600	0.17
204-12	3/4	1.8504	1.2200	0.8465	0.5512	0.295	1/4-28UNF	0.189	0.165	0.531	1.311			0.18
FJ-SA205	25	52	31	21.5	15	7.5	M6X1	4.8	4.3	13.5	38.1	14000	7850	0.20
205-13	13/16	2.0472	1.2200	0.8465	0.5906	0.295	1/4-28UNF	0.189	0.169	0.531	1.5			0.24
205-14	7/8													0.22
205-15	15/16													0.21
205-16	1													0.19
FJ-SA206	30													62
206-17	1-1/16	2.4409	1.4060	0.9370	0.6299	0.354	5/16-24UNF	0.236	0.197	0.626	1.752	0.34		
206-18	1-1/8											0.32		
206-19	1-3/16											0.30		
206-20	1-1/4											0.28		
FJ-SA207	35											72	38.9	25.4
207-20	1-1/4	2.8346	1.5310	1.0000	0.6693	0.374	5/16-24UNF	0.268	0.220	0.689	2.189	0.53		
207-21	1-5/16											0.50		
207-22	1-3/8											0.48		
207-23	1-7/16											0.45		
FJ-SA208	40											80	43.7	30.2
208-24	1-1/2	3.1496	1.7210	1.1890	0.7087	0.433	5/16-24UNF	0.268	0.232	0.720	2.374	0.67		
208-25	1-9/16											0.64		
FJ-SA209	45	85	43.7	30.2	19	11.0	M8X1	6.8	6.1	18.3	63.5	32700	20900	0.66
209-26	1-5/8	3.3465	1.7210	1.1890	0.7480	0.433	5/16-24UNF	0.268	0.240	0.720	2.500			0.75
209-27	1-11/16													0.71
209-28	1-3/4													0.68
FJ-SA210	50											90	43.7	30.2
210-29	1-13/16	3.5433	1.7210	1.1890	0.7874	0.433	5/16-24UNF	0.268	0.256	0.720	2.752	0.85		
210-30	1-7/8											0.81		
210-31	1-15/16											0.77		
210-32	2											0.73		
FJ-SA211	55											100	48.4	32.5
211-32	2	3.9370	1.9060	1.2795	0.8268	0.472	3/8-24UNF	0.315	0.276	0.815	3.000	1.13		
211-33	2-1/16											1.08		
211-34	2-1/8											1.03		
211-35	2-3/16											0.98		
FJ-SA212	60											110	53.1	37.2
212-36	2-1/4	4.3307	2.0910	1.4646	0.8661	0.532	3/8-24UNF	0.315	0.291	0.878	3.315	1.45		
212-37	2-5/16											1.39		
212-38	2-3/8											1.32		
212-39	2-7/16											1.26		